



EMBASSY SUITES

by HILTON™

Albuquerque, New Mexico

All-suite hotel is near the University of New Mexico and the Albuquerque Convention Center and is three miles from Albuquerque International Sunport.

Minutes from...

- Historic Old Town Albuquerque
- Sandia Peak
- Balloon Fiesta Park
- ABQ BioPark
- UNM Championship Golf Courses
- Tingley Beach
- Nob Hill
- University of New Mexico
- Isleta Casino

1000 Woodward Place NE Albuquerque, NM 87102

Tel: 505-245-7100

www.embassysuitesalbuquerque.com



LOCATION

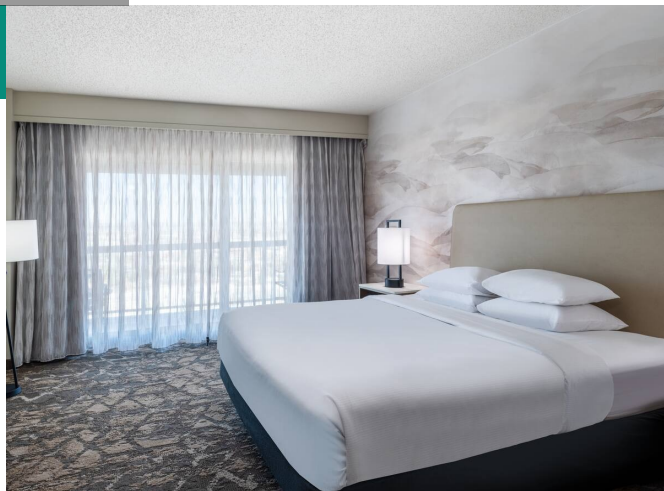

ACCOMMODATIONS

- Newly renovated guest suites (261)
- Refresh Lobby and Atrium
- Complimentary, cooked-to-order breakfast
- Complimentary Evening Reception
- Heated indoor pool
- Cyprus Grille featuring contemporary dining

MEETINGS AND EVENTS

- 30,000 square feet. of event space
- Separate convention center entrance
- Ballroom accommodates 1,500 guests
- Minutes from the airport



Room/27	Length	Width	Ceiling	SQ FT	Classroom 3 per Table	Theatre	Reception	Rounds of 10
Sandia I	26'	38'	18'	988	50	80	100	40
Sandia II	26'	38'	18'	988	50	80	100	40
Sandia III	26'	38'	18'	988	50	80	100	40
Sandia I,II,III	79'	38'	18'	3,002	150	240	300	150
Sandia IV	79'	38'	18'	3,002	150	240	300	150
Sandia V	79'	38'	18'	3,002	150	240	300	150
Sandia VI	26'	38'	18'	988	50	80	100	40
Sandia VII	26'	38'	18'	988	50	80	100	40
Sandia VIII	26'	38'	18'	988	50	80	100	40
Sandia VI, VII, VIII	79'	38'	18'	3,002	150	220	300	100
Sandia Ballroom	152'	79'	18'	12,008	600	1,000	1,500	600
Sierra I	26'	49'	14'	1,274	70	100	150	60
Sierra II	26'	49'	14'	1,274	70	100	150	60
Sierra III	26'	49'	14'	1,274	70	100	150	60
Sierra Jr Ballroom	79'	49'	14'	3,874	200	300	500	180
Ocotillo II	44'	30'	12'	1,320	60	70	150	50
Ocotillo I	39'	28'	12'	1,092	50	60	125	40
Pinon	27'	17'	12'	459	20	30	40	20
Agave	27'	19'	12'	513	25	30	40	20
Sage				Fixed seating for 10				
La Ventana	48'	69'	12'	3,312	150	200	300	120

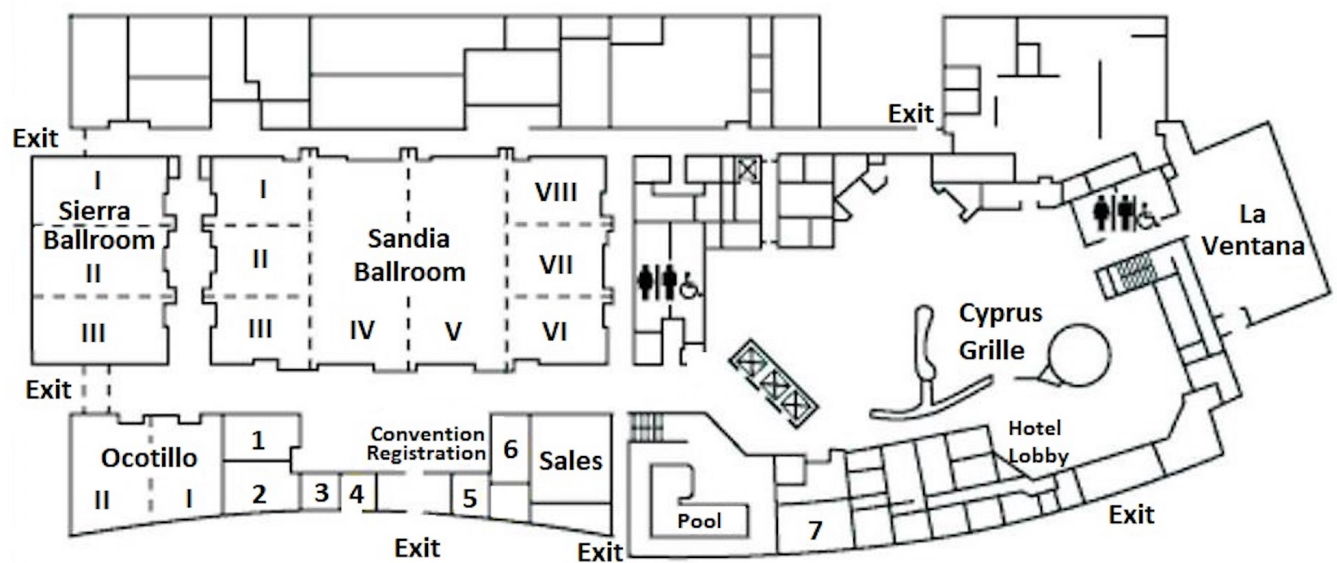

- 1. Pinon
- 2. Agave
- 3. Business Center
- 4. Banquet Office
- 5. Registration Storage
- 6. Sage
- 7. Fitness Center